

# HiCOZY

## USER MANUAL

ELECTRIC SPIN SCRUBBER

HS1 Pro

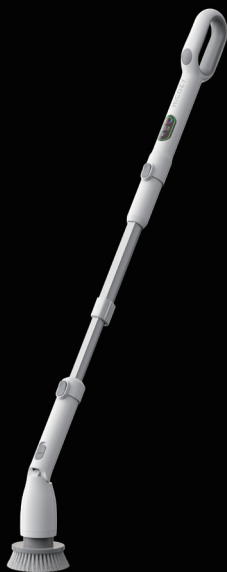

VERSION: 1.1

# CATALOG

INTRODUCTION	03
WARNING	04
PACKAGE INCLUDES	07
DIAGRAM	08
DIMENSIONS	08
PREPARATION	09
USAGE INSTRUCTIONS	13
MAINTENANCE	20
SPECIFICATIONS	21
TROUBLESHOOTING/FAQ	22
WARRANTY PERIOD	24

# INTRODUCTION

This product is designed for household and bathroom cleaning. This scrubber makes it easy to clean hard-to-reach corners like in bathtubs, sinks, and more without excessive bending or reaching. We hope you enjoy your new electric spin scrubber!

Thank you again for choosing HiCOZY. Questions or concerns? You are welcome to contact us via [support@hicozy.com](mailto:support@hicozy.com)



Please fully read and understand this manual before using and keep this manual for future reference.

# WARNING

## SAFETY WARNING

- Due to shipping requirements, this product will arrive with a low battery. Please fully charge it before the first use.
- When scrubbing stains, back splattering may occur. Take precautions to ensure the splatter does not contact your eyes or skin.
- The battery level symbol and charging indicator will flash when the battery level is too low. When this occurs, charge it as soon as possible.
- The charging indicator will flash when it is charging.
- When it is done charging, the charging indicator will illuminate for 10 seconds and turn off. When this occurs, disconnect the power cord.
- After charging, reinsert the charging cover into the charging port to prevent water from entering it.
- Please ensure all the accessories are included in the package after receiving this product.
- Please ensure the brushes are correctly installed before use.
- The brush may scratch surfaces made of stainless steel, polishing resin, artificial marble, and wood. Before cleaning any of these surfaces with this scrubber, try it on a small area first.
- After 30 minutes of continuous operation, there will be an indication beep. This reminder does not force the machine to turn off or otherwise affect continuous use.
- The brushes are consumables, so they are excluded from the warranty.
- Keep the power cord and your hands dry while charging to avoid any damage or injury.
- Please do not personally disassemble, repair, or modify any of the components. Please contact us if there are any quality issues.

- Please wear appropriate eye protection and rubber gloves when cleaning irritating substances.
- Please turn the product off before replacing any accessories.
- Keep all body parts, including hair and clothes, away from the brushes to avoid tangling.

## SAFETY INFORMATION

**Note:** Please practice the safety precautions outlined below when using this product:

- The product is not a toy. Close supervision is required when children are near the product. Keep out of reach of children.
- Do not burn the battery, it may explode in the fire.
- Do not charge the product in a humid or moist environment.
- To achieve better performance, do not charge the product at a temperature below 40 °F (5 °C) or higher than 105 °F (40 °C).
- If the power cord/plug is damaged or broken, please replace it with a qualified power cord.
- Do not use the power cord improperly. Do NOT use the power cord to lift the product or violently unplug it.
- Do not store or use the product close to any heat sources.

## WARNING

- This appliance can be used by children older than 8 years as well as persons with reduced physical, sensory, or mental capabilities or lack of experience and knowledge, ONLY if they have been given proper supervision and instruction concerning the use of this appliance. Children shall not play with this appliance. Cleaning and maintenance shall not be performed by children without supervision.

- This appliance is not intended for use by persons (including children) with reduced physical, sensory, or mental capabilities, or lack of experience and knowledge unless they have been given supervision or instruction concerning the use of the appliance by a person responsible for their safety. Children should be supervised to ensure that they do not play with the appliance.

## FCC STATEMENT

- Operation is subject to obey the below conditions.
- This device may not cause harmful interference.
- This device must accept any interference received, including interference that may cause undesired operation.

**Note:** This equipment has been tested and found to comply with the limits for a Class B digital device, pursuant to part 15 of the FCC Rules. These limits are designed to provide reasonable protection against harmful interference in a residential installation. This equipment generates, uses, and can radiate radio frequency energy and, if not installed and used in accordance with the instructions may cause harmful interference to radio communications. However, there is no guarantee that interference will not occur in a particular installation. If this equipment does cause harmful interference to radio or television reception, which can be determined by turning the equipment off and on, the user is encouraged to try to correct the interference by one or more of the following measures

- Reorient or relocate the receiving antenna.
- Increase the separation between the equipment and the receiver.
- Connect the equipment to an outlet on a circuit different from that to which the receiver is connected.
- Consult the dealer or an experienced radio/TV technician for help.

# PACKAGE INCLUDES

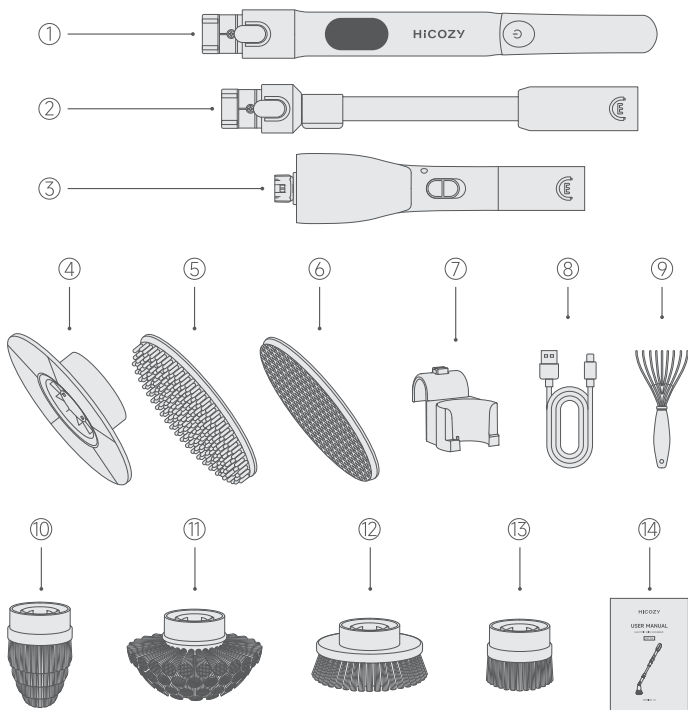

- |                    |                         |                    |
|--------------------|-------------------------|--------------------|
| ① Main Handle      | ⑥ Cleaning Cloth        | ⑪ Dome Brush       |
| ② Extension Handle | ⑦ Hanging Hook          | ⑫ Large Flat Brush |
| ③ Scrubber Head    | ⑧ Type-C Charging Cable | ⑬ Small Flat Brush |
| ④ Hook & Loop Tray | ⑨ Hair Comb             | ⑭ User Manual      |
| ⑤ Chenille Cloth   | ⑩ Corner Brush          |                    |

## DIAGRAM

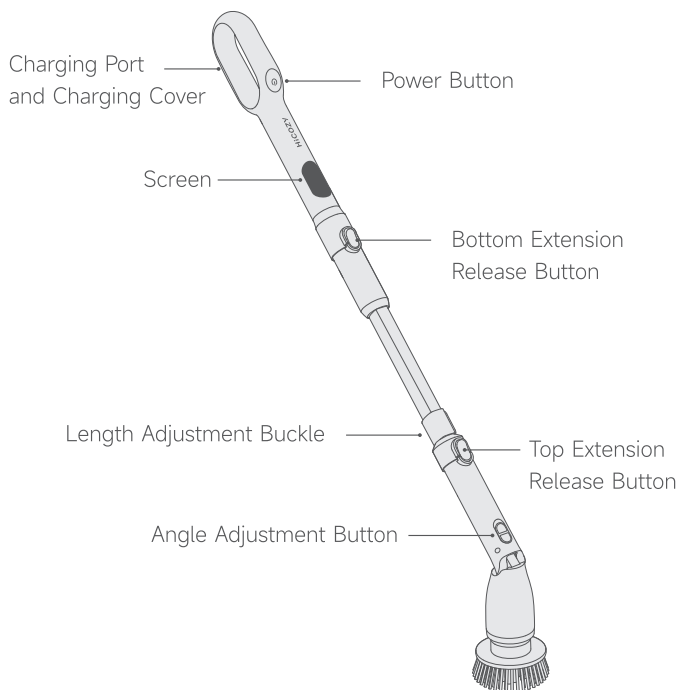

## DIMENSIONS

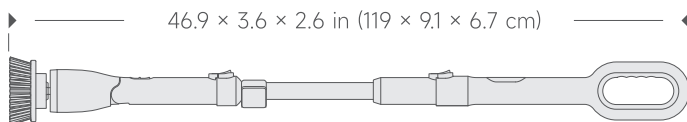



# PREPARATION

## INSTALLATION INSTRUCTIONS

**Note:** Before assembling any component of this product, make sure the device is turned off.

### Assemble with Extendable Handle

Completed assembly as shown in the picture.

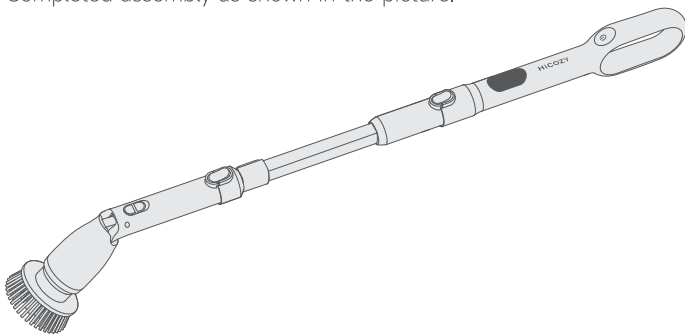

1. Connect the main handle to the extendable handle until you hear a "CLICK" sound.

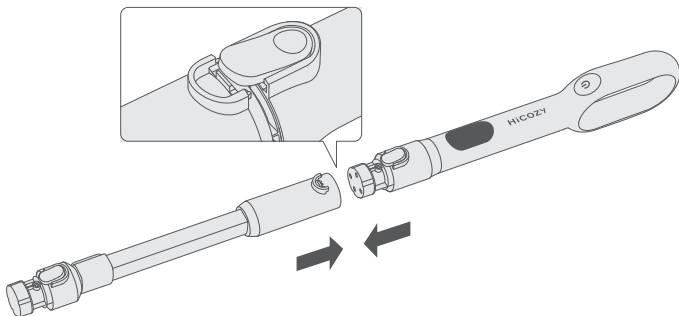

2. Next, connect the scrubber head to the extendable handle until you hear a “CLICK” sound.

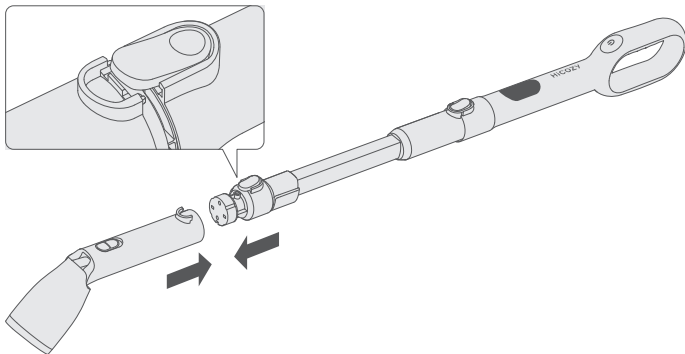

#### Assemble without Extendable Handle

Connect the main handle to the scrubber head until you hear a “CLICK” sound. Note the following diagram.

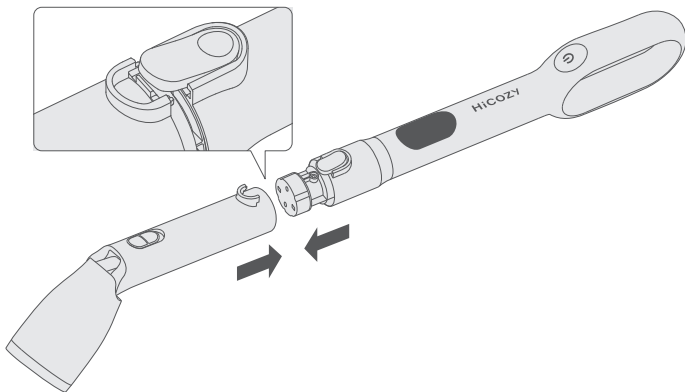

## Brush Head Assembly

Push the selected brush on until it is securely fastened. Firmly hold the scrubber head with one hand and press the two pieces together.

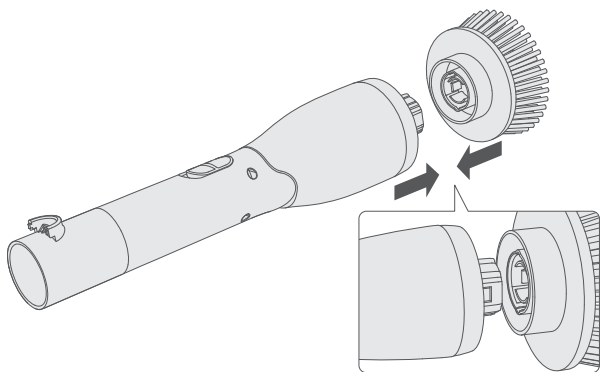

## How to Pull Out the Brush Head

Hold the connection part of the brush head and pull it out vertically.

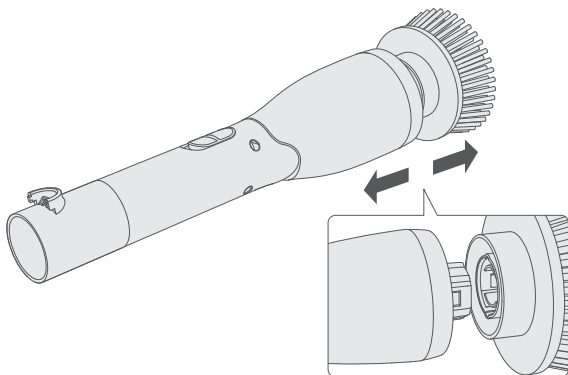

## How to Use the Hanging Hook

You can install the hook onto a bar or rod to hang the electric spin scrubber.

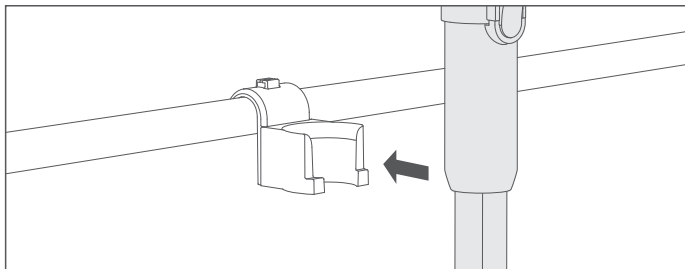

## How to Charge

Open the silicone charging cover and insert the charging cable. Then, plug the type-c charging cable into the electrical outlet.

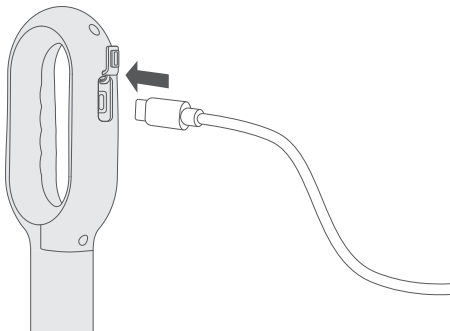

**Reminder:** Due to shipping requirements, the product's battery will be low upon arrival. When the battery level symbol and charging indicator flash slowly, please charge it as soon as possible. It will work normally after being fully charged.

# USAGE INSTRUCTIONS

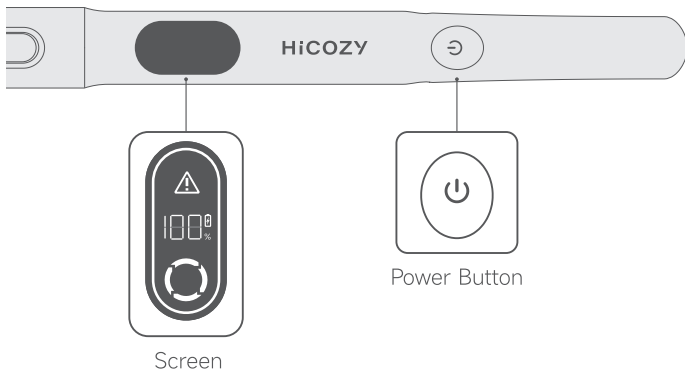

## POWER BUTTON

- Press and hold the Power Button to turn on the first gear (speed of 180 RPM).



**Note:** The screen displays the corresponding gear and current battery level.

- Press the Power Button for a second time to turn on the second gear (speed of 240 RPM).
- Press the Power Button for a third time to turn on the third gear (speed of 300 RPM).
- Press the Power Button for a fourth time to turn on the fourth gear (speed of 400 RPM).
- Pressing a fifth time will return to first gear. Press and hold the Power Button to turn off the machine; the screen will also turn off.
- If the battery level is too low, it will automatically turn off.

## AUDIO INDICATION

The buzzer will beep to indicate different statuses during the Power Button operation:

Icon	Condition	Indication	Audio	Solution
	1st Gear	1 Indicator Illuminated	1 Beep	/
	2nd Gear	2 Indicator Illuminated	1 Beep	/
	3rd Gear	3 Indicator Illuminated	1 Beep	/
	4th Gear	4 Indicator Illuminated	1 Beep	/
	Charging	Illuminated battery level symbol + Flashing charging indicator	/	/
	Fully Charged	Battery level symbol and charging indicator illuminates for 10 seconds then turns off	/	/
	Current Battery Power	Battery Level Display	/	Realtime battery level indication, measured in 5% increments

Icon	Condition	Indication	Audio	Solution
	Low Battery Level	Slowly flashing battery level symbol and charging indicator	5 Beeps	0% Low battery level, promptly charge the device
	Low Battery Indication	Slowly flashing battery level symbol and charging indicator	5 Beeps	20% Low Battery Indication
	Locked	Quickly-Flashing Error Symbol	3 Beeps	The brush is locked, restart it
-	30 Minutes of Continuous Use	/	3 Sets of 4 Beeps	30 Minutes Indication Beep

**Note:** Do not apply too much pressure to the brush. Excessive force will trigger its circuit protection and cause the scrubber to automatically turn off. Restart the brush to continue using it.

## CODE ANALYSIS

### E1

**Error:** Poor Parallel Connection Between the Batteries

**Solution:** Malfunctioning batteries, contact customer support to replace

### **E3**

**Error:** Low Charging Voltage

**Solution:** Use the 5 V = 2 A charger to charge it. If the error persists, contact customer support to replace

### **E4**

**Error:** High Charging Voltage

**Solution:** Use the 5 V = 2 A charger to charge it. If the error persists, contact customer support to replace

### **E5**

**Error:** Continuously Charging for >18 Hours

**Solution:** Promptly disconnect the charger after it is fully charged

### **E6**

**Error:** >3.0 V Difference Between Batteries

**Solution:** Battery error, contact customer support to replace



## SCRUBBER HEAD ANGLE ADJUSTMENT INSTRUCTION

Slide the Angle Adjustment Button, then adjust the angle according as needed.

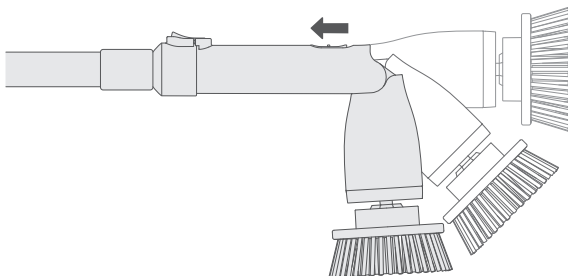

## EXTENSION ROD OPERATION

Open the length adjustment buckle and pull the handle to extend, then adjust the length as needed. After that, buckle up the length adjustment buckle.

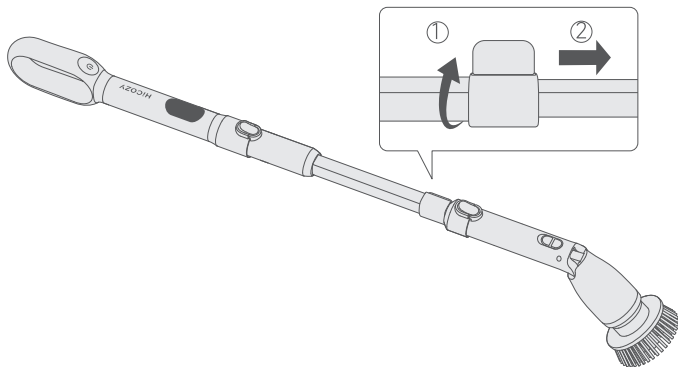

## ACCESSORIES USAGES



### Dome Brush

The round brush is a concave cleaning brush good for cleaning showers, tubs, bathtubs, sinks, baseboards or toilets.

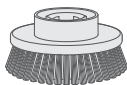

### Large Flat Brush

The large flat brush is used to clean large flat surface areas, like hard floors, tiles, walls, doors, windows, glass, counters, patio furniture, pools, soap scum, grime, stoves, carpet and ceramic surfaces.

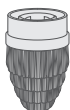

### Corner Brush

The corner brush is great for cleaning tile grout, edges, corners and tight places.



### Small Flat Brush

The small flat brush is ideal for cleaning smaller areas such as showers, kitchens, soap scum, grime, grease, stoves, grills, counters and doors.

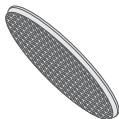

### Cleaning Cloth Brush

This brush head consists of two parts - the cleaning pad itself and the hook & loop fasteners that attach to the scrubber. Place the cleaning pad as close to the center as possible. This attachment is suitable for window or plane cleaning.

## Chenille Brush



This attachment consists of two parts - the chenille itself and hook & loop fasteners that attach to the scrubber. Place the chenille as close to the center as possible. Great for cleaning cars, windows, and similar surfaces to protect the surface from wear and grime. Helpful for removing soap residue and water stains.

**Tip:** If you want to buy more replacement brush heads, just search "HiCOZY Replacement Brush Head" on Amazon.

# MAINTENANCE

## HOW TO CLEAN THE PRODUCT

**Handle Part:** Gently wipe the handle part of the scrubber with a wrung soft cloth.

**Brush Head:** Disassemble the brush head and immerse it in water to clean. Clean it with neutral detergent if it is difficult to clean.

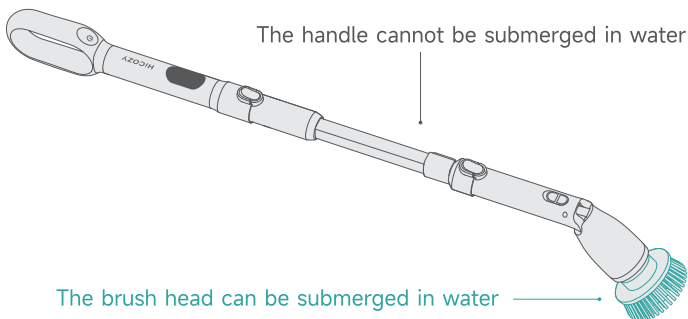

### Cleaning Note

- For better cleaning, it is recommended to use the brush with a detergent (such as mold & mildew remover, water stain remover, oven cleaner, bleach cleaner, all-purpose cleaner, etc.). Use different detergents as needed.
- For removing stubborn stains, soak stains in water and detergent for a while (10 minutes or longer). Then, use the scrubber to clean it, this will shorten your cleaning time.

**Storage Note:** Store the scrubber in a ventilated and cool place. Avoid placing it in a wet area or exposing it to strong sunlight.

## SPECIFICATIONS

Product	Cordless Power Scrubber
Model	HS1 Pro
Battery Capacity	3000 mAh
Battery Type	Li-ion Battery
Voltage	7.4 V
Rotation	180-400 RPM
Charging Time	4-4.5 Hours
Running Time	90 Minutes
Noise	<70 dB
Input Voltage	Standard Charging 5 V $\overline{=}$ 2 A
Certificate	FCC

# TROUBLESHOOTING/FAQ

## WHY DOES THE CHARGING INDICATOR NOT FLASH WHEN CHARGING

- Check if the socket is powered or if there is a power blockage.
- If the battery level symbol and charging indicator illuminate for 10 seconds after powering, the screen display 100%, this indicates the product is fully charged. Press the Power Button to start scrubbing.

## THE CHARGING INDICATOR FAILS TO REACH 100% BATTERY LEVEL AFTER 4-5 HOURS OR MORE OF CHARGING

- Please check if the connection between the socket and the product is secure before charging.
- If water enters the product during operation, it will damage the interior circuit and lead to abnormal charging.
- Please contact HiCOZY Customer Support if other issues appear.

## THE BRUSH STOPS ROTATING WHEN WORKING

- If the error symbol flashes for 30 seconds and then stops, the user may be pressing too hard on the brush. The brush automatically stops due to its protection system.  
Press the Power Button once to restart the device.
- If the battery level symbol and charging indicator keep flashing, the device's battery is low. Use the device after fully charging it.
- If the product stops rotating after spinning less than 10 seconds or does not resume spinning after pressing the Power Button once. Please contact HiCOZY Customer Support via [support@hicozy.com](mailto:support@hicozy.com)

## **THE CHARGING INDICATOR SHOWS 100% (FULLY CHARGED), BUT THE BRUSH DOES NOT SPIN**

- Please check if the brush is securely connected to the extension rod and handle. For installation instructions, please check the "Preparation" section of this manual.
- If all the connections are secure and the device has not been soaked in water before; but the brush does not spin after turning on or the brush stops spinning when the user applies gentle force, please contact HiCOZY Customer Support via email.

## **WHEN THE BATTERY IS FULLY CHARGED, THE BRUSH HEAD SPINS FOR LESS THAN 90 MINUTES OR DOES NOT WORK**

Users may apply different downforce during the operation. If you keep pressing the brushes too hard, the operation time will be shorter than 90 minutes. To extend its service life, please do not press the brushes too hard. Frequent hard-pressing will damage the brushes.

# WARRANTY PERIOD

## 1-YEAR LIMITED WARRANTY FROM HiCOZY

For the Period of

One year from the date of the original purchase

### Warranty Covers

If the electric spin scrubber fails due to a defect in materials or workmanship, during the limited one-year warranty, HiCOZY will either replace your product with a new product or refund the purchase price of the product at HiCOZY's sole discretion.

### What HiCOZY Will Not Cover

- Service trips to your home.
- Improper maintenance.
- Incidental or consequential damage caused by possible defects with this appliance.
- Labor and other charges to install and/or remove the product.
- The normal consumption of brushes.

Each HiCOZY electric spin scrubber will be free from defects in material and workmanship. This warranty does not cover damage from neglect, misuse, contamination, alteration, accident, or abnormal conditions of operation or handling. This warranty covers the original purchaser only and is not transferable.

HiCOZY always wants to provide our customers with excellent products and customer service.

Questions or concerns? We're happy to help!

Please contact us via [support@hicozy.com](mailto:support@hicozy.com)



**HiCOZY**