

HiCOZY

USER MANUAL

ELECTRIC SPIN SCRUBBER

HSE1

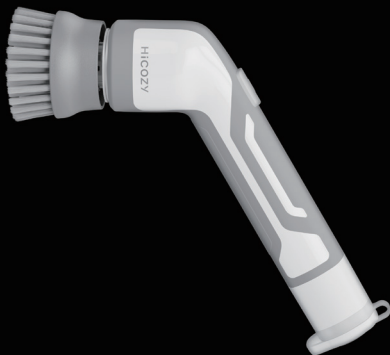

VERSION: 1.2

CATALOG

INTRODUCTION	03
WARNING	04
DIMENSIONS	07
PACKAGE INCLUDES	08
DIAGRAM	09
PREPARATION	09
USAGE INSTRUCTIONS	12
MAINTENANCE	14
SPECIFICATIONS	15
TROUBLESHOOTING/FAQ	15
WARRANTY PERIOD	17

INTRODUCTION

This product is designed for household and bathroom cleaning. This scrubber makes it easy to clean hard-to-reach corners in cooktops, bathrooms, sinks and more without excessive bending or reaching. We hope you like your new electric spin scrubber!

Thank you again for choosing HiCOZY. Questions or concerns? You are welcome to contact us via support@hicozy.com.



Please fully read and understand this manual before using and keep this manual for future reference.

WARNING

SAFETY WARNING

- Due to shipping requirements, the product will arrive with a low battery. Please fully charge it before first use.
- When scrubbing stains, back splattering may occur. Take precautions to ensure the splatter does not contact your eyes or skin.
- The indicator will flash in red when the battery level is too low, please charge it as soon as possible.
- The indicator will illuminate red when it is charging. If the indicator does not illuminate red, please check if the charging cable is inserted correctly, then check the indicator.
- Please close the charging port cover after charging to prevent water from entering the scrubber's internals.
- Please ensure all the accessories are included in the package after receiving the product.
- Please ensure the brushes are correctly installed before use.
- The brush may scratch surfaces made of stainless steel, polishing resin, artificial marble and wood. Before cleaning any of these surfaces with this scrubber, try it on a small area first.
- Let the product rest for at least 10 minutes after 30 minutes of continuous operation.
- The brushes are consumables, so they are excluded from the warranty.
- Keep the charging cable and your hands dry while charging to avoid any damage or injury.

- Please do not personally disassemble, repair or modify any of the components. Please contact us if there are any quality issues.
- Please wear appropriate eye protection and rubber gloves when cleaning irritating substances.
- Please turn the product off before replacing any accessories.
- Keep all body parts, including hair and clothes, away from the brushes to avoid tangling.

SAFETY INFORMATION

Note: Please practice the safety precautions outlined below when using this product:

- The product is not a toy. Close supervision is required when children are near the product.
Keep out of reach of children.
- Do not burn the battery, it may explode in the fire.
- Do not charge the product in a humid or moist environment.
- To achieve better performance, do not charge the product at a temperature below 40 °F (5 °C) or higher than 105 °F (40 °C).
- If the charging cable/plug is damaged or broken, please replace it with a qualified charging cable.
- Do not use the charging cable improperly. Do NOT use the charging cable to lift the product or violently unplug it.
- Do not store or use the product close to any heat sources.

FCC STATEMENT

Operation is subject to obey the below conditions:

1. This device may not cause harmful interference.
2. This device must accept any interference received, including interference that may cause undesired operation.

Note: This equipment has been tested and found to comply with the limits for a Class B digital device, pursuant to part 15 of the FCC Rules. These limits are designed to provide reasonable protection against harmful interference in a residential installation. This equipment generates, uses and can radiate radio frequency energy and, if not installed and used in accordance with the instructions may cause harmful interference to radio communications. However, there is no guarantee that interference will not occur in a particular installation. If this equipment does cause harmful interference to radio or television reception, which can be determined by turning the equipment off and on, the user is encouraged to try to correct the interference by one or more of the following measures:

- Reorient or relocate the receiving antenna.
- Increase the separation between the equipment and receiver.
- Connect the equipment to an outlet on a circuit different from that to which the receiver is connected.
- Consult the dealer or an experienced radio/TV technician for help.

SAFETY ALERT

- This appliance can be used by children older than 8 years as well as persons with reduced physical, sensory or mental capabilities or lack of experience and knowledge, ONLY if they have been given proper supervision or instruction concerning use of the appliance. Children shall not play with the appliance. Cleaning and maintenance shall not be performed by children without supervision.
- This appliance is not intended for use by persons (including children) with reduced physical, sensory or mental capabilities, or lack of experience and knowledge unless they have been given supervision or instruction concerning use of the appliance by a person responsible for their safety. Children should be supervised to ensure that they do not play with the appliance.

DIMENSIONS

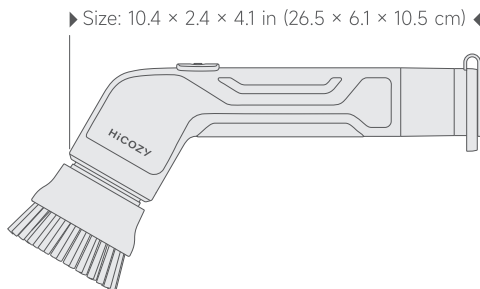

PACKAGE INCLUDES

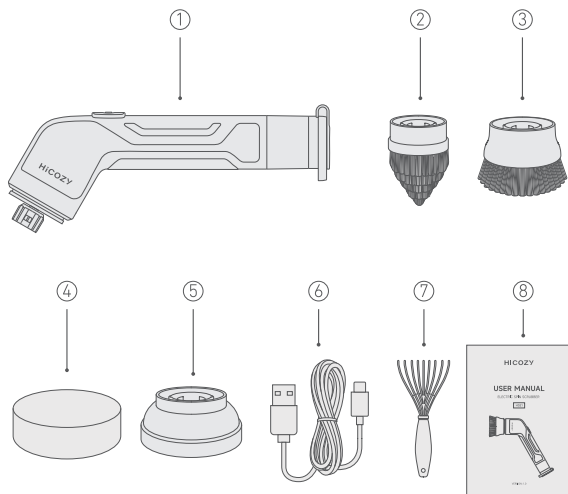

- | | |
|----------------|-------------------------------------|
| ① Grip | ⑤ Cleaning Pad and Hook & Loop Tray |
| ② Corner Brush | ⑥ Type-C Charging Cable |
| ③ Hard Brush | ⑦ Hair Comb |
| ④ Sponge | ⑧ User Manual |

DIAGRAM

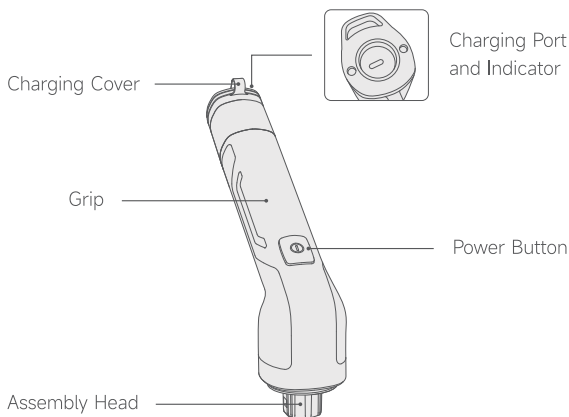

PREPARATION

INSTALLATION INSTRUCTIONS

Note: Before assembling any component of this product, make sure the device is turned off.

Brush Head Assembly

Firmly hold the scrubber head with one hand and then press the selected brush on until secured.

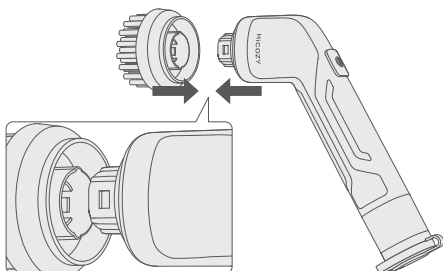

How to Pull Out the Brush Head

Hold the connection part of the brush head and pull out vertically.

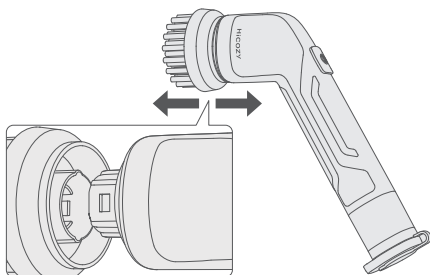



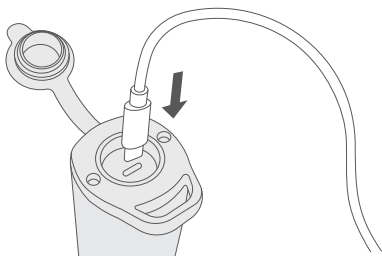

How to Charge

Open the silicone charging cover and insert the cable for charging. Next, plug the adapter into an electrical outlet. (Please fully charge the product before first use.)



LED Indicator

	Light	State
	Red Light	Charging
	Green Light	Fully Charged/Working
	Slow Flash	Low Battery Protection
	Quick Flash	Locked-Rotor Protection

Reminder: Due to factory testing, the product's battery will not be full upon arrival. When the indicator light flashes slowly, please charge it as soon as possible. It will work functionally after being fully charged.

USAGE INSTRUCTIONS

HOW TO ADJUST THE SPEED

Press the Power Button once for high gear, press twice for low gear and press it three times to power off.

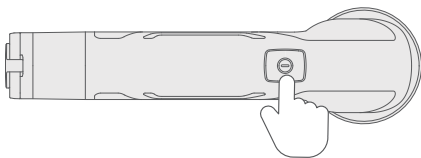

Note: Do not overuse. It will turn off automatically due to circuit protection. When it is locked, please turn it on again for reuse.

WATERPROOF NOTE

This electric spin scrubber is IPX7 waterproof, the entire grip section can be used in water for a short time.

Note: IPX7 means this product can be submerged in water for 30 minutes at a depth of 1 meter without affecting its functionality. Excessive submergence will damage the device. Please ensure the charging plug is tightly plugged.

ACCESSORIES USAGES



Hard Brush

Suitable for cleaning larger areas like floors, tiles, sinks, tubs, etc.



Corner Brush

This brush is suitable for cleaning joints, corners and niches.

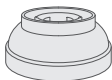

Cleaning Pad

The accessory consists of two parts - the cleaning pad itself and a plastic bracket that attaches to the device. The cleaning pads are attached to the associated plastic brackets by hook & loop fasteners. Place the cleaning pad in the center of the plastic holder. This accessory is suitable for scrubbing larger surfaces like tiles, tubs, shelves, etc.

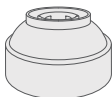

Sponge

The accessory consists of two parts - the sponge itself and a plastic holder attached to the device. Place the sponge in the center of the plastic holder whenever possible. This accessory is suitable for scrubbing large surfaces like glass, mirrors, etc.

Tip: If you want to buy more replacement brush heads, please search "HiCOZY Replacement Brush Head" on Amazon.

MAINTENANCE

HOW TO CLEAN THE PRODUCT

Handle Part: Gently wipe the handle part of the scrubber with a wrung soft cloth.

Brush Head: Disassemble the brush head and immerse it in water to clean. If it is difficult to clean, use a neutral detergent.

Handle Part cannot be soaked in water

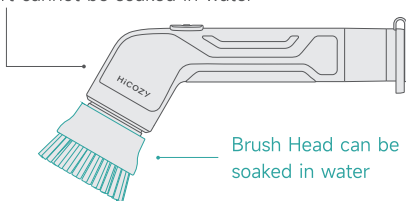

Cleaning Note

- For better cleaning, HiCOZY recommends using the brush with a detergent (Such as Mold & Mildew Remover, Water Stain Remover, Oven Cleaner, Bleach Cleaner, All-Purpose Cleaner, ect.). Use different detergents for different needs.
- For removing stubborn stains, please soak the stains with water and detergent for a while (10 minutes or longer), and then use the scrubber to clean them. This will make cleaning them quicker and easier.

Storage Note: Store the scrubber in a ventilated and cool place. Avoid placing it in an area that is wet or exposed to strong sunlight.

SPECIFICATIONS

Product	Cordless Power Scrubber
Model	KS-2625E
Battery Capacity	2500 mAh
Battery Type	Lithium-ion Battery
Voltage	DC 3.7 V
Rotation	210-300 RPM
Charging Time	3.5-4 Hours
Running Time	High Gear 60 Min/Low Gear 90 Min
Noise	<75 dB
Charger Output	Standard Charging 5 V \equiv 1 A
Certificate	FCC

TROUBLESHOOTING/FAQ

THE RED INDICATOR WILL NOT LIGHT UP WHEN CHARGING

- Check if the socket is powered or if there is a power blockage.
- If the indicator turns green after powering, this indicates the product is fully charged. Press the Power Button to start.

THE INDICATOR STAYS RED AFTER 4 HOURS OR MORE OF CHARGING

- Please check if the connection between the socket and product is secure. Secure it before charging.
- If water enters the product during operation, it will damage the interior circuit and lead to abnormal charging.
- Please contact HiCOZY Customer Service if other issues appear.

THE INDICATOR IS GREEN (FULLY CHARGED), BUT THE BRUSH DOES NOT SPIN

- Please check if the brush is connected tightly to the extension rod and handle. For installation instructions, please check the installation instruction part of this manual.
- If all the connections are connected well and the device has not been soaked in water before; but the brush does not spin after turning on or the brush stops spinning when the user applies gentle force, please contact HiCOZY Customer Service via email.

THE BRUSH HEAD SPINS FOR LESS THAN 60 MINUTES OR DOES NOT WORK AFTER PRESSING THE POWER BUTTON ONCE WHEN THE BATTERY IS FULLY CHARGED

- Users may apply different downforce during the operation. If you keep pressing the brushes too hard, the operation time will be shorter than 60 minutes. To extend its service life, please do not press the brushes too hard, or the frequent hard-pressing will damage the brushes.

THE BRUSH STOPS ROTATING WHEN WORKING

- If the red indicator flashes for 30 seconds and then stops, the user may be pressing too hard on the brush; the brush automatically stops due to its protection system. Press the Power Button once or twice to restart the device.
- If the red indicator keeps flashing, it is indicating a low battery. Use the device after fully charging it.
- If the product stops rotating after spinning for less than 10 seconds, or the spin does not resume after pressing the Power Button twice. Please contact HiCOZY Customer Service via email.

WARRANTY PERIOD

1-YEAR LIMITED WARRANTY FROM HiCOZY

For the Period of:

One year from the date of the original purchase.

Warranty Covers:

If the electric spin scrubber fails due to a defect in materials or workmanship, during the limited one-year warranty, HiCOZY will either replace your product with a new product or refund the purchase price of the product at HiCOZY's sole discretion.

What HiCOZY Will Not Cover:

- Service trips to your home.
- Improper maintenance.
- Incidental or consequential damage caused by possible defects with this appliance.
- Labor and other charges to install and/or remove the product.
- The normal consumption of brushes.

Each HiCOZY Electric Spin Scrubber will be free from defects in material and workmanship. This warranty does not cover damage from neglect, misuse, contamination, alteration, accident, or abnormal conditions of operation or handling. This warranty covers the original purchaser only and is not transferable.

HiCOZY always wants to provide our customers with excellent products and customer service.

Questions or concerns? We're happy to help!

Please contact us via support@hicozy.com.

HiCOZY