



Electric pump

Electric Air Pump

User Manual

■

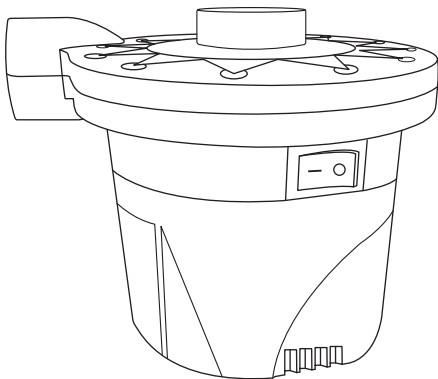

Model : 8328
- V1.0 -

Thank you for purchasing the electric air pump from AstroAI. Designed by several electrical engineers, this electric air pump is continuously being tested so as to bring you the best inflation experience. This electric pump is equipped with a good quality lithium-ion battery pack, which can inflate outdoors. It also has a large power motor that provides excellent air pressure and air volume performance. This means that it can inflate objects within a very short time. Before operating the electric air pump, please read the user manual carefully and keep the manual for future reference. We hope that the new electric air pump will bring you a joyful experience. Thank you again for choosing AstroAI. If you have any questions or concerns regarding your product, please contact us using support@astroai.com.



Please fully read and understand this manual before using this product and keep this manual for future reference.

WARNING ///

- Small accessories are included. Children are not allowed to operate the electric pump.
- Please read the instructions carefully before use. Please note that incorrect use may damage the electric pump.
- Place the electric pump in a dry place and away from direct sunlight.
- Do not randomly detach or modify the electric pump.
- Keep the electric pump away from heat sources, fires, and corrosive liquids.
- Do not use or store the electric pump in a humid environment.
- Do not use the electric pump for other purposes.
- Please allow the electric pump to cool for a period of at least 5 minutes after every 15 minutes of use.
- Do not let the hair, gravel, stone, and other foreign objects into the electric pump, they will make the electric pump unable to work or even burn out.
- When the electric pump is working, please don't use your eyes to observe the Inflatable/deflatable Nozzles when it's working.
- Do not put your fingers into any of the electric pump's gaps.
- After charging, disconnect the power supply within the appropriate time.

- The electric pump contains a lithium-ion battery that should not be thrown away randomly.
- Guided by the properties of lithium-ion batteries, please note that when not in use, ensure that you charge and discharge the electric pump every 3 months to guarantee its best performance.
- Omissions and accidents may happen during the packaging or shipping of the electric pump. You're therefore advised to contact our support team if you have any of the following problems:
 - ① The pump does not work.
 - ② Lack of accessories.
 - ③ Damaged power cord or damaged body.

DIAGRAM

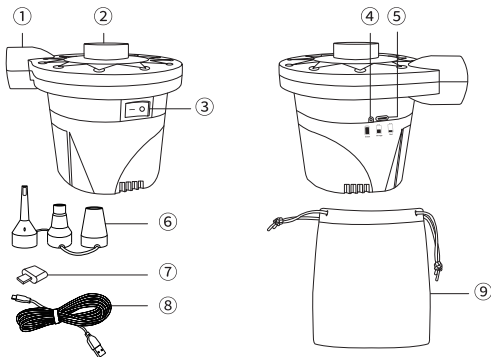

- | | |
|-----------------------------------|----------------------------------|
| ① Inflate Port | ② Deflate Port |
| ③ Switch | ④ Battery Indicator |
| ⑤ USB Type-C Charging Port | ⑥ Interlocking Nozzles |
| ⑦ USB Type-C to USB-A OTG Adapter | ⑧ USB-A to USB Type-C Power Cord |
| ⑨ Flannel Storage Bag | |

INSTRUCTIONS ///

- Choose a suitable nozzle to correctly connect the electric pump to the inflatable objects and press the '-' switch to make the pump work.

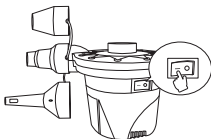
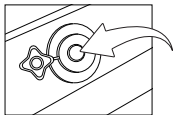

- Press the 'O' switch after inflation and the pump will stop.

CHARGING METHOD

- The indicator will display different color codes based on the corresponding battery levels as indicated below:

- ① Green: sufficient power.
- ② Orange: insufficient power, charge the pump in a short time.
- ③ Red: low power - charge the pump in a minute.

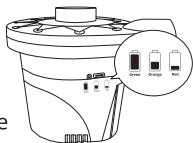

- Use the attached data cable to charge the electric pump (with a mobile adapter). In addition, the OTG adapter has been attached for Type-C users. The OTG adapter may be connected as instructed below:

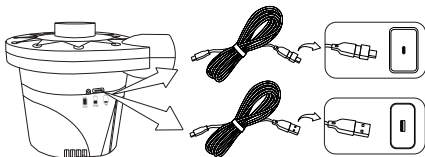

- The battery indicator will indicate red when the electric pump is being charged and green when the pump is fully charged. Please note that the electric pump cannot inflate objects when it is in charging mode.
- Furthermore, the OTG adapter not only charges mobile devices but also supports OTG-compatible mice, keyboards, USB flash drives, etc. The OTG adapter may be connected as instructed below:

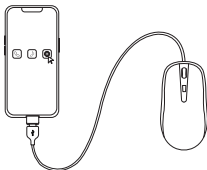

TROUBLE-SHOOTING //

Q: The pump does not work.

A: Please ensure the battery level is sufficient.

Q: The pump is unable to charge.

A: Please ensure the charger works functionally.

SPECIFICATIONS ///

Model	8328
Input	5 V  2 A
Battery capacity	2000 mAh
Battery voltage	7.4 V
Maximum air volume	350 L/min
Maximum pressure	0.65 PSI
Continuous operating time	15 minutes
Charging time	5 hours
Power cord length	1 meter, 39.37 inches

PACKAGE INCLUDED ///

- 1 x Lithium Battery Electric Pump
- 1 x Interlocking Nozzles
- 1 x OTG Adapter
- 1 x Power Cord
- 1 x Flannel Storage Bag
- 1 x User Manual

RECYCLING //

You may dispose of the product when its service life has ended, please recycle the recyclable parts according to local guidelines.

WARRANTY PERIOD //

1- Year Warranty Limited Warranty From AstroAI.

Each AstroAI electric pump will be free from defects in material and workmanship. This warranty does not cover damages caused by negligence, misuse, contamination, alteration, accident, or abnormal conditions of operation or handling. This warranty covers the original purchaser only and is not transferable.

Have any questions or concerns? We're happy to help! Please contact us via support@astroai.com.



Web: www.astroai.com

■ E-mail: support@astroai.com
