

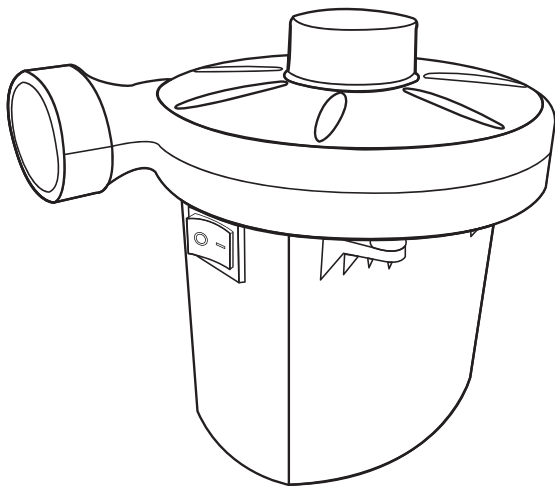

# Electric Air Pump Air Mattress Portable Pump User Manual



Model: 8211  
- V 1.2 -

Thank you for purchasing the Air Mattress Portable Pump from AstroAI. In order to ensure the best performance and safety, please read and follow the instructions before use. For future reference, please keep the instructions. We hope you can enjoy your new Air Mattress Portable Pump. If you need any help and support from our customer service team, you are welcome to contact us via [support@astroai.com](mailto:support@astroai.com). Thank you again.

## **WARNING //**

- Please read the instructions carefully before use.
- Please keep the product in a dry place and away from direct sunlight.
- DO NOT modify this product at will.
- Please keep the product away from fire, corrosive liquid and strong acid.
- DO NOT use or store in a humid environment.
- DO NOT use the product for other purposes.
- Please do not let your product work for more than 10 minutes and take at least 3 minutes off.
- DO NOT let the hair, gravel and stone into the pump, they will make the pump unable to work or even burn out.
- When the pump is working, please do not observe the Inflatable and deflatable nozzles, which may hurt your eyes.
- DO NOT put your fingers into the gap of the pump anytime, or it will hurt your fingers.
- When using DC supply power through the car, please make sure to start your car first.
- DO NOT block the heat dissipation port when working.

Accidents may occur during shipping, please contact our support team if you experience any of the following problems:

- The pump does not work.
- Lack of accessories.
- Damaged power cord or damaged body.

## DIAGRAM

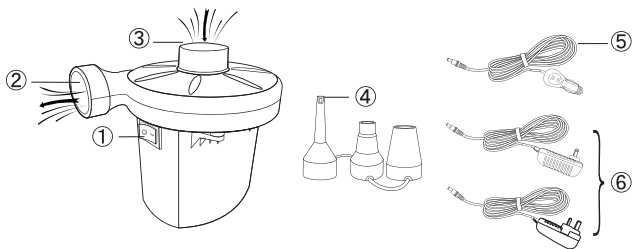

- ① Switch
- ② Inflatable Nozzle
- ③ Deflatable Nozzle
- ④ 3 Interlocking Nozzles
- ⑤ Cigarette Lighter
- ⑥ AC Adapter(This product contains one adapter only.  
The adapter shape may differ slightly based on the local standard.)

## FEATURES

### BODY

- Made of new high strength ABS plastic; special surface treatment technology and unique shape help you to have a better experience when using; extra length of the power cord can make your operation more flexible.

## NOZZLES

- Three kinds of practical Nozzles perfectly match most of your inflatable items and wear-resistant materials greatly improve the service life of the Nozzles.

## PRODUCT EFFICIENCY

- Compatible with AC and DC dual power supply; versatile use; high-performance motor can quickly inflate and deflate your items; suitable for large inflatable items.

### INSTRUCTIONS

- Before starting, please press the 'O' Switch, insert the cylindrical plug into the hole, and then insert the plug into the AC socket (insert the 12V adapter or car cigarette lighter when using vehicles).

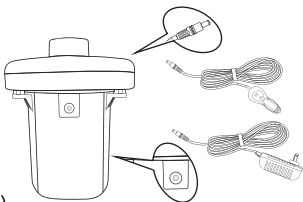

- According to the Nozzles type of items you want to inflate (deflate), choose the appropriate Nozzles and accurately insert the 'inflatable 'or' deflatable' Nozzles, and then press the '—' switch, the air pump will work.
- When the inflatable item is filled to the appropriate pressure (or vacuum), please press the 'O' switch, and unplug the plug or cigarette lighter.



## **PRODUCT SPECIFICATIONS** ///

Input Voltage	DC 12V
Output Power	60W
Maximum Gas Flow	300L/min
Maximum Pressure	0.5 PSI
Maximum Working Time	10 min
AC Power Cord Length	2.5 meters/98.4 in
DC Power Cord Length	3 meters/118 in

## **TROUBLESHOOTING** ///

Q: The pump does not work?

A: Please ensure that socket or cigarette lighter has power and the switch '—' is on.

Q: Poor performance of inflating/deflating?

A: Please ensure that the deflatable nozzles do not block by any objects.

## **PACKAGE CONTENTS** ///

1x Air Mattress Portable Pump

1x 3 Interlocking Nozzles

1x AC Adapter

1x DC Cigarette Lighter

1x User Manual

## **1 YEAR WARRANTY LIMITED WARRANTY FROM ASTROAI** //

Each AstroAI Air Mattress Portable Pump will be free from defects in material and workmanship. This warranty does not cover damage from neglect, misuse, contamination, alteration, accident, or abnormal conditions of operation or handling. This warranty covers the original purchaser only and is not transferable. Any questions or concerns? Please feel free to contact us.

AstroAI always wants to provide our customers with excellent products as well as customer service. To know more about us, please visit [astroai.com](http://astroai.com).



Web: [www.astroai.com](http://www.astroai.com)

E-mail: [support@astroai.com](mailto:support@astroai.com)

---